

Blinds4You

Fitting Guide for **Wooden blinds/Faux Wooden blinds**

Now you have received your new Wooden blind from us, fitting for your new blind is easier than you might think! All you have to do is follow our simple tips, double-check everything you do and set aside some time to do it.

This guide works for:

- Wooden blinds
- Faux Wooden blinds

Fitting into standard window

Fitting the brackets

The brackets offer three methods of installation:

Top fixing

Where the brackets are screwed into the lintel (or 'ceiling' of the recess).

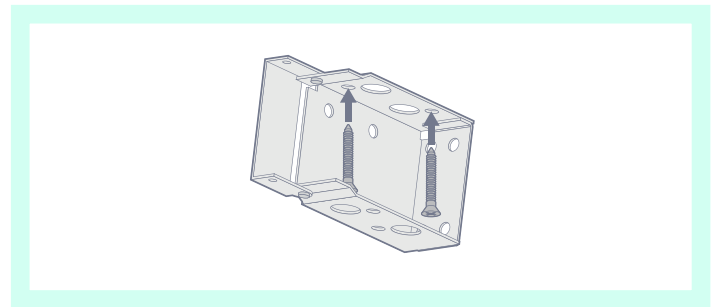

Side fixing

Where the brackets are screwed into the side walls of the recess.

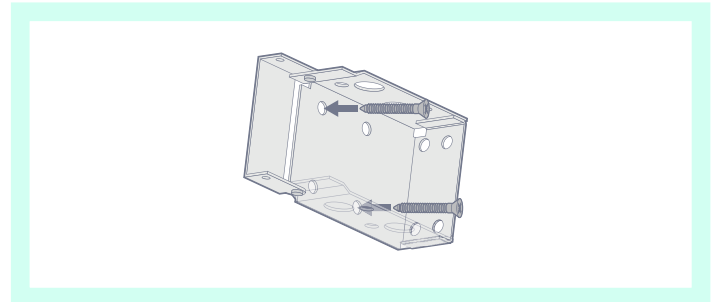

Face fixing

Where the brackets are screwed onto a facing surface (a wall or window frame).

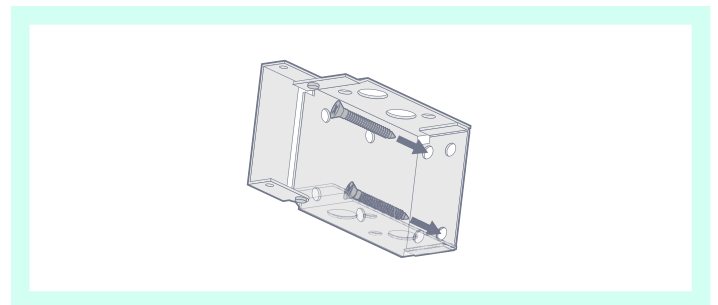

Support brackets

Wider blinds will be supplied with support brackets. These should be positioned towards the centre of the window area in-line with the box brackets. Make sure that the position of the support bracket is clear of any cords coming out of the head rail. Support brackets can be top-fixed or face-fixed (see illustrations opposite).

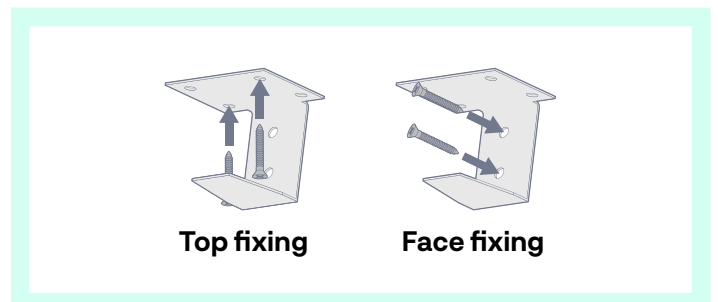

Fitting the blind

If you are fitting the blind inside a recess, go to step 3 before step 2.

Lift the blind to the window and slot the head rail into the open brackets.

Swing the hinged section of the bracket closed and press firmly until it locks.

Handy Tip: If you pull the cords to tilt the blind but the slats do not move:



- Make sure the slats are open and that the tilt cords are both the same length.
- Stack the blind up tightly and lock it off, then take it down from the brackets.
- Push the metal rod inside the head rail all the way over to the left, so that it is connected to the tilting mechanism.

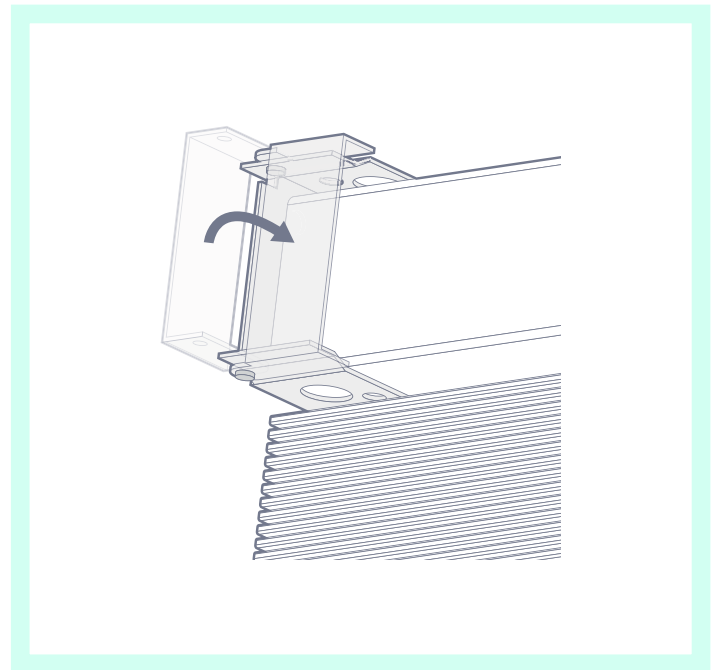

Fitting the pelmet

Attach the winged clips to the rear of the pelmet and hook the serrated pelmet clips onto the head rail (if installing the blind within a recess, this should be done before step 2) so that both the serrated clips and winged clips are in corresponding positions on the head rail and pelmet. Then align the two clips with each other and apply gentle pressure to the front of the pelmet, directly over the clips to click them together.

Step 1

Hook the valance clips evenly along the length of the head rail, prior to installing the blind in the brackets.

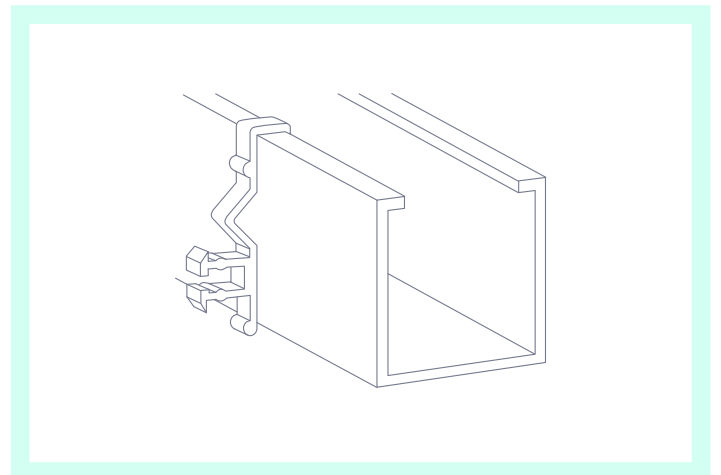

Step 2

Engage the top leg of the valance clip into the groove on the back of the valance. Then push the valance towards the head rail to engage the bottom leg.

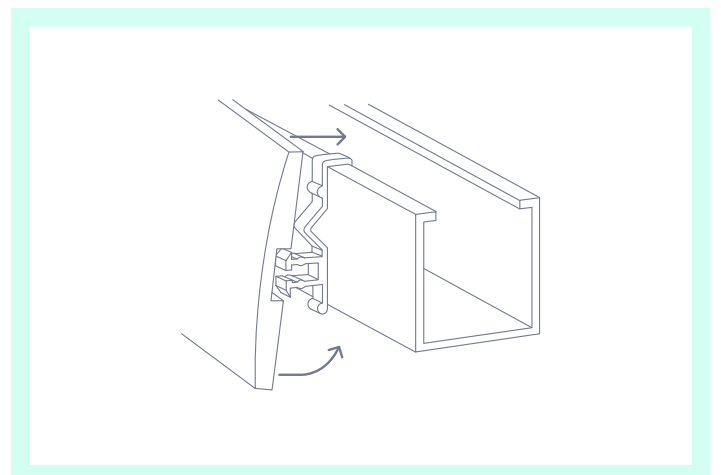

Pelmets for Exact Fitting

If you've ordered 'exact fitting' then the pelmet will be sent wider and mitred at the ends, with additional end returns to cover the brackets. Use the 'L' shaped plastic brackets from your fittings pack to attach the side returns to the pelmet.

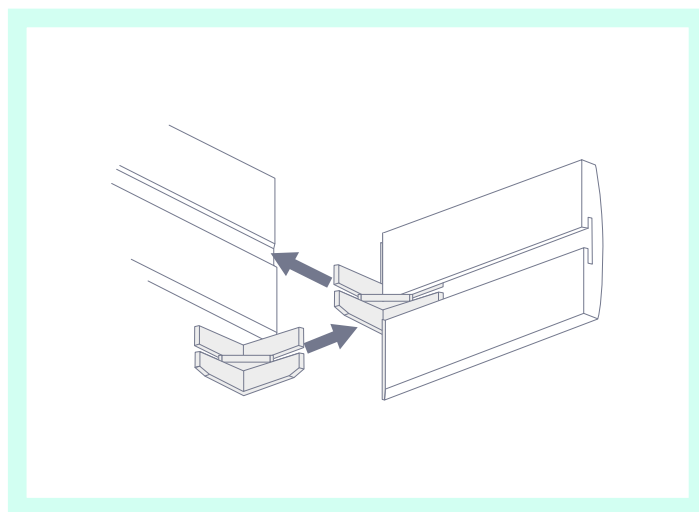

Child safety

A breakaway cord condenser is pre-fitted to the lift cords so that when a horizontal force is applied to the cords above the condenser, it safely breaks away, eliminating any hazardous loops.

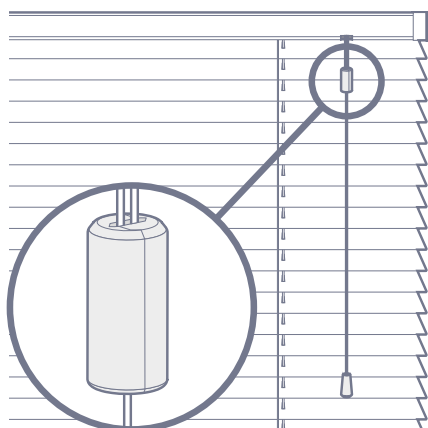

If the cord condenser is pulled apart: untangle and untwist cords.

For 2 cords: Press the cord condenser together until it is fully closed.

For 3 cords: Place the loose cord in the opening in one half of the cord condenser and press the cord condenser together until it is fully closed.

For 4 cords: Place one of the loose cords in the opening in one half of the cord condenser, the remaining loose cord in the opening in the other half and press the cord condenser together until it is fully closed.

If there are any doubts that the cord condenser has not been re-attached correctly it can be tested by placing your arm between the cords and pressing downwards. The condenser should break apart with minimal force, if it does not breakaway tie cords out of reach of children and contact a reputable blind company to repair the blind.

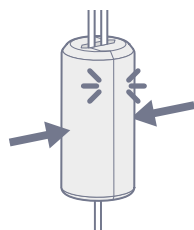
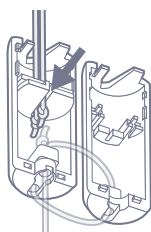

Handy Tip: The design of the condenser can vary, so don't worry if yours doesn't look exactly like the illustration. Both designs do the same job and clip back together in the same way.



Cord Safety Cleat

The safety cleat shall be installed as close to the head rail as possible and in all cases not less than 1500mm from the floor. The cord must be fully accumulated around the safety cleat(s) when the blind is not in use. Use the table below to determine the distance required between the cleats to fully accumulate the cords when the blind is fully raised.

Drop of blind	*Distance between cord cleats (centre to centre)
1-1000mm	100mm
1001-2000mm	150mm
2001-3000mm	300mm

Step 2

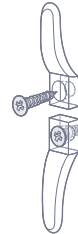

Mark the hole positions and drill as required. Use the screws provided to attach the safety cleat to the wall.

Step 1

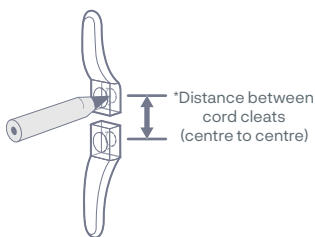

Place the safety cleat in the desired position on the wall and mark the positions of the holes with a pencil.

Step 3



Wrap the cords around the cord cleats in a figure of 8. When the cords are fully accumulated, ensure they are secure so that when any cord is pulled, no excess cord is released.

Enjoy your newly installed blind from Blinds 4 You

We are here to help you enjoy your new blinds and you will find lots of other useful information on our website. If you need to contact us, please visit www.blinds4you.co.uk/contactus for more details.